

Note  
Tree sizes on plan shown indicative only - Planting size varies.  
The Hedge will be saplings 15cm-60cm in height  
and the trees will be a mixture of saplings and cell grown trees.

Trees + hedges		Latin name	mature Height *	Av Mature Spread
A1	= Ash (common /European)	Fraxinus excelsior	23m	8m
B1 + 2	= Beech (common)	Fagus sylvatica	20m	8m
Ch1 + 2	= Cherry (plum)	Prunus cerasifera	5-7m	3-6m
H1 + 2	= Holly (common /English)	Ilex aquifolium	12m	4m
H/Ch	= Horse Chestnut	Aesculus hippocastanum	20m	>10m
Mag	= Magnolia	Magnolia x soulangeana	9m	5m
Mu	= Mulberry	Morus nigra	9m	10m
S1 - S6	= Silver birch	Betula pendula	14m	8m
Wa1	= Walnut	Juglans Regia	18m	8m
W1	= Weeping Willow	Salix babylonica	16-20m	10-12m

Native hedging to include :-  
Hawthorn, hazel, holly, blackthorn + dogrose.

\* Heights taken from NHBC Ch 4.2 - building near trees

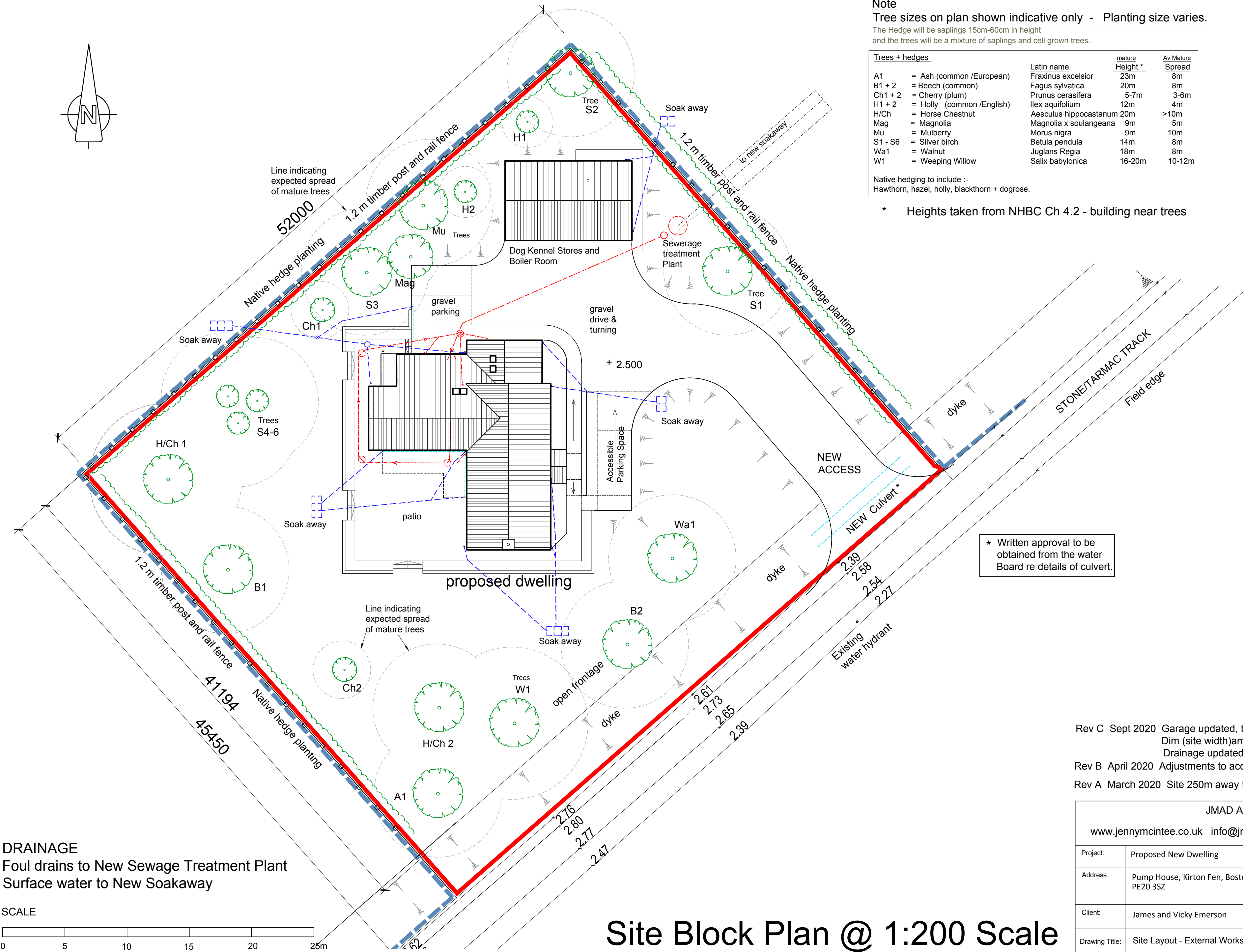

\* Written approval to be  
obtained from the water  
Board re details of culvert.

Rev C Sept 2020 Garage updated, trees shown + Patio area updated  
Dim (site width) amended to suit approved drg 102.  
Drainage updated slightly + Tree types shown  
Rev B April 2020 Adjustments to accommodate raised floor level  
Rev A March 2020 Site 250m away from reservoir bank

JMAD Architecture			
www.jennymcintee.co.uk info@jmadarch.co.uk Tel 07921 003153			
Project:	Proposed New Dwelling	Date:	April 2020
Address:	Pump House, Kirtton Fen, Boston PE20 3SZ	Scale:	1:200 on A2
		drawn:	TW checked: JM
Client:	James and Vicky Emerson	Job No:	19080
Drawing Title:	Site Layout - External Works	Dwg No:	103 C

Site Block Plan @ 1:200 Scale